

# Quaker Memorial Presbyterian Church Community Garden

2013 to Present

Established in 2013  
Funded by gifts and 2 small grants

Three goals were established by the Garden Committee

- Provide healthy fruits and vegetables to those in need
- Build community
- Teach people about gardening and healthy eating

Quaker Memorial Presbyterian Church's  
**Community Vegetable Garden**

Thank you for stopping by to look at our garden!

**100%** of the garden's produce is donated to food agencies

*If you are in need of food please visit us when we are working in the garden so that we can connect you with the local food agencies.*

A few of the agencies we serve:



**MIRIAM'S HOUSE**  
SOLUTIONS TO HOMELESSNESS

Please check us out!  
[www.qmpcgarden.wordpress.com](http://www.qmpcgarden.wordpress.com)  
[www.QMPC.org](http://www.QMPC.org)



# Spring of 2013 Members of QMPC formed a Garden Committee

Planted spinach, lettuce and peas and raised a fence of deer netting.



# It snowed within a week of planting our first garden!

The summer of 2013 was hot and dry and we didn't have many plants that did well – maybe donated 50 pounds to Miriam's House and Daily Bread



2014 a few more people with gardening experience joined.  
We expanded to growing in straw bales



# 2014: We were surprised at our harvest

We produced about 200 pounds of food



# 2015 more Gardeners joined

Wrapped the straw bales to maintain moisture and used drip hose irrigation from water barrels





# In 2015 we wanted to expand the QMPC Community Garden

- During the summer of 2015 we started dreaming about raised beds and then we learned of the community garden grants that were being offered by the City of Lynchburg
- We applied for the community garden grant
  - Proposed 4 raised beds
  - Built raised beds where the straw bales were located
  - Wire fence around the garden
- When local friends and businesses heard about what we were doing they offered up funds and supplies that allowed the construction of the 2 U shaped beds encircling the existing garden

# 2015 Dream of a expanded Garden

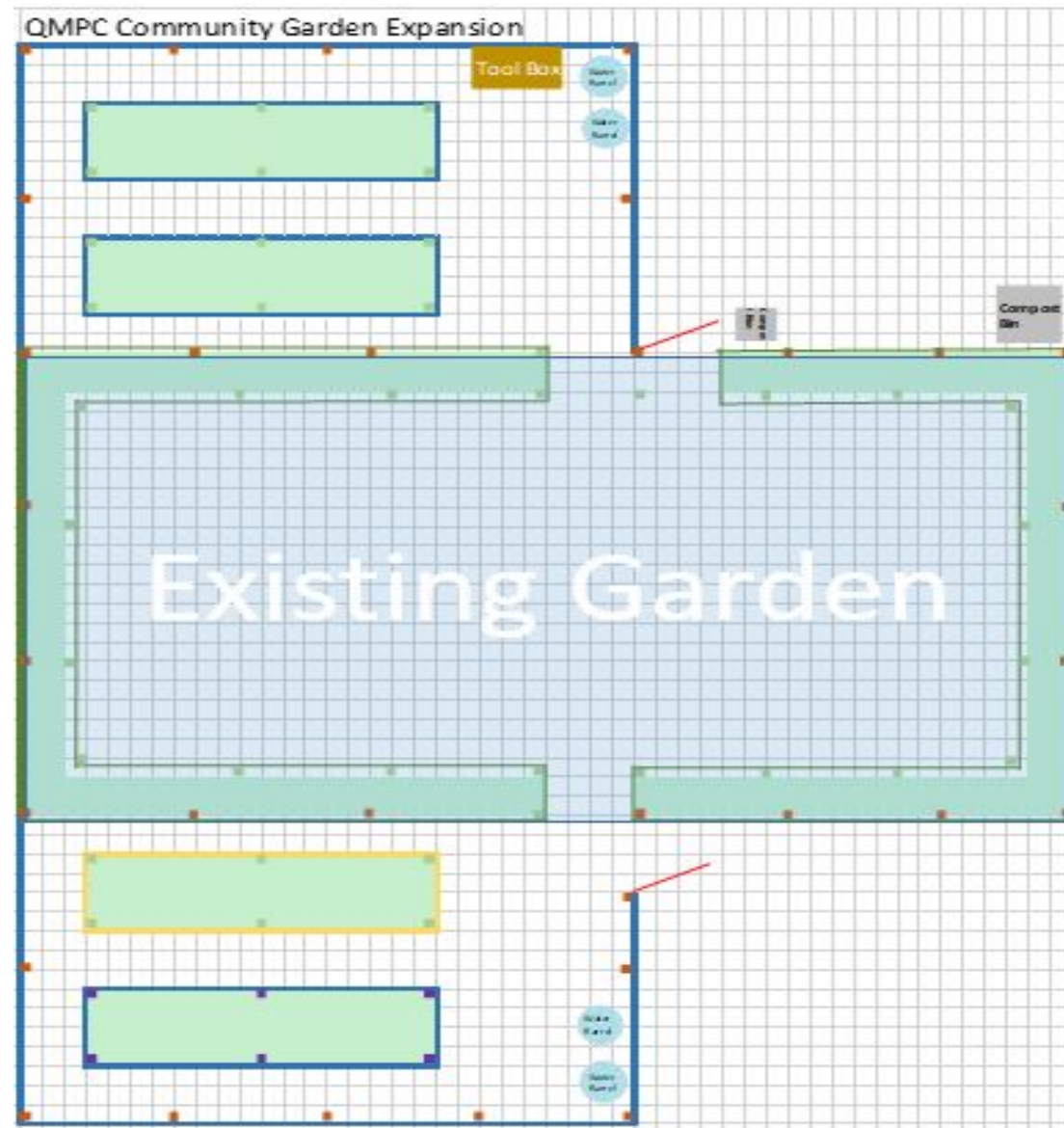

# 2016 Dream of a expanded Garden work begins









# Filling empty raised beds for Spring Planting 2016













# Day School planting a spring Garden



Added 4 compost bins in 2017



# Added beehive and paintings in 2018



Added underground water line from church to garden in 2019









Veggies harvested over the years!























# Estimated Veggies donated 2013 to present

- Total Veggies Donated in 2013: ~50 lbs
- Total Veggies Donated in 2014: ~200 lbs
- Total Veggies Donated in 2015: ~670.31 lbs
- Total Veggies Donated in 2016: 842.87 lbs
- Total Veggies Donated in 2017: ~862.98 lbs
- Total Veggies Donated in 2018: 784.21 lbs
- Total Veggies Donated in 2019: 754.85 lbs
- Total Veggies Donated in 2022: 1130.39 lbs